

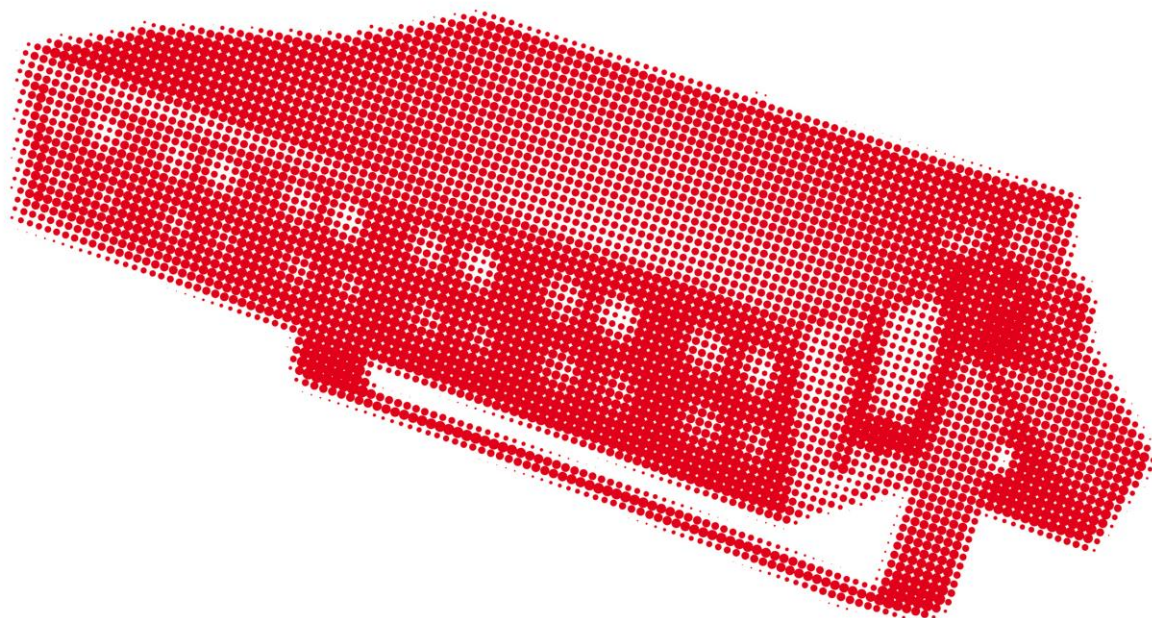

PROFESSIONAL LED COLOR CHANGER USER MANUAL



QUADRO B 24

KEEP THIS MANUAL FOR FUTURE NEEDS



Introduction

Thank you for using QUADRO B24. This unit is a DMX intelligent LED wash light that can be used as a stand alone or a sound-active mode. The unit can also be controlled via Wireless DMX.

QUADRO B24 has been thoroughly tested and has been shipped in perfect operating condition. Carefully check the shipping carton for damage that may have occurred during shipping. If the carton appears to be damaged, carefully inspect your unit for any damage and be sure all accessories necessary to operate the unit has arrived intact. In the case damage has been found or parts are missing, please contact the manufacturer or your dealer for further instructions. Do not return this unit to your dealer without first contacting.

To optimize the performance of this product, please read these operating instructions carefully to familiarize you with the basic operations of this unit.

These instructions contain important safety information regarding the use and maintenance.

GENERAL GUIDELINES

This device is a lighting effect for professional use on stages, in discotheques, theatres, etc..

This fixture is only allowed to be operated with the max alternating current which stated in the technical specifications of this manual, the device was designed only for indoor use.

Lighting effects are not designed for permanent operation. Consistent operational breaks may ensure that the device will function properly for a long time.

Do not shake the device. Avoid brute force when installing or operating the device.

The device shall only be used complete with its protective shield.

While choosing the installation-spot, please make sure that the device is not exposed to extreme heat, moisture or dust. The minimum distance between light-output from the projector and the illuminated surface must be more than 0.1 meter.

Operate the device only after having familiarized with its functions. Do not permit operation by persons not qualified. Most damages are the result of unprofessional operation.

Please use the original packaging if the device is to be transported.

For safety reasons, please be aware that all modifications on the device are forbidden.

If this device will be operated in any way different to the one described in this manual, the product may suffer damages and the guarantee becomes void. Furthermore, any other operation may lead to short-circuit, burns, electric shock, crash, etc..

FEATURES

3 pin xlr dmx input and output connectors, input and output powerconn connectors

Wireless Transmitter and Receiver Onboard

7/24/27 DMX 512 Channel Mode

Stand Alone with Master/Slave function and sound activated via Built in Microphone

Multi-Colors, Color strobe, Electronic Dimming 0-100%

2 x 16 LCD operation menu with function buttons

Daisy Chain Units Together with or without cables

SAFETY INSTRUCTIONS



CAUTION!

Be careful with your operations. With a dangerous voltage you can suffer a dangerous electric shock when touching wires!

This device has left the factory in perfect condition. In order to maintain this condition and to ensure a safe operation, it is absolutely necessary for the user to follow the safety instructions and warning notes written in this user manual.



Important:

Damages caused by the disregard of this user manual are not subject to warranty. The dealer will not accept liability for any resulting defects or problems.

- This device falls under protection-class I. Therefore it is essential that the device be earthed.
- Be sure that the local power outlet match that of the required voltage for your unit.
- The electric connection must carry out by qualified person.
- No move at operating mode.
- To reduce the risk of electrical shock or fire, do not expose this unit to rain or moisture.
- Do not spill water or other liquids into or on to your unit.
- Do not attempt to operate this unit if the power cord has been frayed or broken.
- Do not attempt to remove or break off the ground prong from the electrical cord.
- Disconnect from main power before making any type of connection.
- Do not remove the cover under any conditions. There are no user serviceable parts inside.
- Never operate this unit when its rear cover is removed.
- Never plug this unit in to a dimmer pack without proper ventilation.
- Always be sure to mount this unit in an area that will allow proper ventilation. Allow about 0.1 meter between this device and a wall.
- Do not attempt to operate this unit, if it becomes damaged.
- This unit is intended for indoor use only; use of this product outdoors voids all warranties.
- During long periods of non-use, disconnect the unit's main power.
- Always mount this unit in safe and stable matter.
- Heat -The appliance should be situated away from each appliance that produce heat.
- Cleaning -The unit should be cleaned only as recommended by the manufacturer. See "Cleaning" for details.



CAUTION!

Never touch the device during operation!
The housing may heat up



CAUTION!

Never look directly into the light source,
as sensitive persons may suffer an epileptic shock.

Please be aware that damages caused by manual modifications to the device are not subject to warranty. Keep away from children and non-professionals.

INSTALLATION INSTRUCTIONS

Mounting the device



CAUTION!

Please consider the EN 60598-2-17 and the other respective national norms during the installation. The installation must only be carried out by a qualified person.

QUADRO B24 can support power supply from 110V to 230V so you need to be sure to connect the machine with the correct voltage.

The applicable temperature is between 0°C~45°C Do not use the lighting under or above the temperature.

The installation of the effect has to be built and constructed in a way that it can hold 10 times the weight for 1 hour without any harming deformation.

The installation must be secured with a secondary safety attachment, an appropriate safety rope.

Never stand directly below the device when mounting, removing or servicing the fixture.

The operator has to make sure the safety relating and machine technical installations are approved by an expert before taking the device into operation for the first time.

These installations have to be approved by a skilled person once a year.

Cautions:

The effect should be installed outside areas where persons may reach it, walk by or be seated.

Overhead mounting requires extensive experience, including amongst others calculating working load limits, installation material being used, and periodic safety inspection of all installation material and the device. If you lack these qualifications, do not attempt the installation yourself. Improper installation can result in bodily injury.



CAUTION!

The electric connection must only be carried out by a qualified electrician.

Before mounting make sure that the installation area can hold a minimum point load of 10 times the device's weight.

Warning!

To prevent or reduce the risk of electrical shock or fire, do not expose this unit to rain or moisture.

Caution!

There are no user serviceable parts inside this unit. Do not attempt any repairs yourself; doing so will void your manufacturer's warranty. In the unlikely event your unit may require service please contact the manufacturer or your dealer.

Panel Instruction

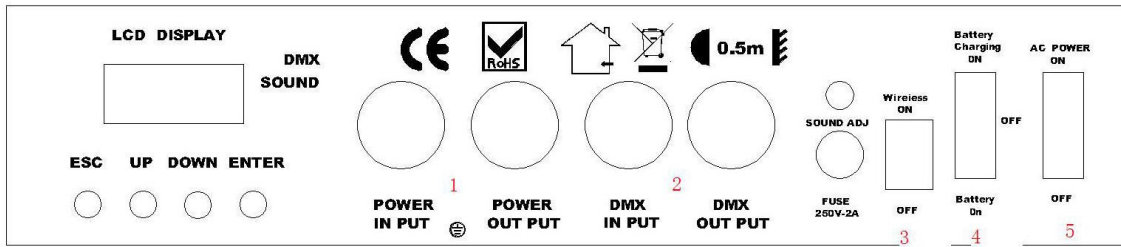

1. Power in and out powerconn connectors.
2. Dmx in and out xlr connectors.
3. On/Off wireless switch.
4. Charge/Off/On Battery selector.
5. On/Off AC selector.

Off

- 3: Off
- 4: Off
- 5: Off

On with AC

- 1: Power plug connected
- 4: Off
- 5: On

On with Battery

- 4: On
- 5: Off

On with dmx cables

- 2: dmx cables connected
- 3: Off

On with Wireless

- 3: On

Charge

- 1: Power plug connected
- 3: Off
- 4: Charge
- 5: On

Battery Indicator

- 1: Battery power: 10%
- 2: Battery power: 50%
- 3: Battery power: 100%
- 4: Charging led
Red color: charging
Green color: full

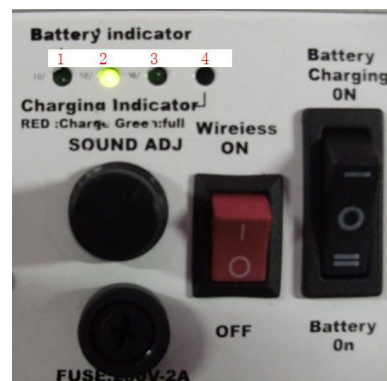

TX/RX/ID Indicator

Steady Red light: no dmx signal

Flashing Red light: dmx signal transmission

Flashing Green light: dmx signal reception

When you have Wireless On, you can choose 7 different working groups by the ID button.

The RX/TX/ID led will show you different color each press:

RED, GREEN, RED+GREEN, BLUE, RED+BLUE, GREEN+BLUE, RED+GREEN+BLUE

Machines with same ID will work together.

Operating Instructions

You can use QUADRO B24 in 4 ways:

- Sound-Active mode - The unit will react to sound, chasing through the built in programs. You can choose the sensitivity by the knob in the panel.
- Auto Mode - The unit will automatically chase through the different colors.
- DMX control mode - This function will allow you to control each individual units traits with a standard DMX 512 controller.
- Master-slave mode – One unit will work as the master in the one of the above three modes, other units in the chain will work in synchronization towards the master.

DMX Mode

Operating through a DMX controller give the user the freedom to create their own programs tailored to their own individual needs. This function also allows you to use your units as spot lights.

1. This function will allow you to control each individual unit's traits with a standard DMX 512 controller.
2. The QUADRO B24 uses 7/24/27 DMX channels to operate. Please see "DMX Values and Functions" for the DMX traits and choose the preferred DMX mode by menu.
3. To run your unit in DMX mode, plug in the unit via the XLR connections to any standard DMX controller. Set your desired DMX address following the setup specifications that come with your DMX controller.

Touch Buttons

There four touch buttons under the LCD display: Esc, Down, Up and Enter.

Normally, the LCD will display in the second line of the LCD screen the current DMX address code, as like: "DMX Address: 001"

When the first line reads: "Select Menu <>", press Func to enter the main menu;

Press Up/Down to scroll in the menu or submenu options;

Press Enter to confirm your selection, and the first line will change to "Select Value <>".

At this time, press Up/Down to change the value in the selected function.

Any time press and hold Up or Down, the value will rapidly change and stop when release.

Once the value is set, press enter again to save and exit to the main menu.

LCD Operation Menu

The brand name will be displayed when the unit is power on. After initialization, it will show the model name. Then, the unit is ready for setting and working. Please see the following table for setting information.

Menu	Function
Sel menu ChModeXX	Channel Mode: 07; 24; 27
Sel menu Addr XXX	Address Selection: 000-255
Sel menu Slave	Slave Mode
Sel menu Sound	Sound Mode
Sel menu Auto	Auto Mode
Sel menu Color XX	Static Colors: 00-15: 00:off ; 01:red; 02:red+green; 03:green; 04:gree+blue; 05:blue; 06:blue+white; 07:white; 08:red+white; 09:green+white; 10:red+blue; 11:green+blue+white; 12:red+green+blue; 13:red+blue+white; 14:red+green+white; 15:red+green+blue+white.
Sel menu ChangXXX	Changing Colors: 000-255 from slow to fast.
Sel menu Fade XX	Fade: 000-015 from slow to fast.

DMX Values and Functions

➤ 7 channels mode:

Channel	Value	Function
1	0-255	Master dimmer
2	0-255	0-10:NoStrobe; 11-245:Master strobe from slow to fast; 246-255:NoStrobe
3	0-255	Color Functions (0-10:NoFunction; 11-127:Color changing from slow to fast; 128-245:Color fade from slow to fast; 246-255:NoFunction)
4	0-255	Red dimmer
5	0-255	Green dimmer
6	0-255	Blue dimmer
7	0-255	White dimmer

➤ **24 Channels mode:**

Channel	Value	Function
1	0-255	first dot red dimmer.
2	0-255	first dot green dimmer.
3	0-255	first dot blue dimmer.
4	0-255	first dot white dimmer.
5	0-255	second dot red dimmer.
6	0-255	second dot green dimmer.
7	0-255	second dot blue dimmer.
8	0-255	second dot white c dimmer.
9	0-255	third dot red dimmer.
10	0-255	third dot green dimmer.
11	0-255	third dot blue dimmer.
12	0-255	third dot white dimmer.
13	0-255	fourth dot red dimmer.
14	0-255	fourth dot green c dimmer.
15	0-255	fourth dot blue dimmer.
16	0-255	fourth dot white c dimmer.
17	0-255	fifth dot red dimmer.
18	0-255	fifth dot green dimmer.
19	0-255	fifth dot blue dimmer.
20	0-255	fifth dot white dimmer.
21	0-255	sixth dot red dimmer.
22	0-255	sixth dot green dimmer.
23	0-255	sixth dot blue dimmer.
24	0-255	sixth dot white dimmer.

➤ **27 Channels mode:**

Channel	Value	Function
1	0-255	Master dimmer
2	0-255	0-10:NoStrobe; 11-245:Strobe from slow to fast; 246-255:NoStrobe
3	0-255	Color Functions (0-10:NoFunction; 11-127:Color changing from slow to fast; 128-245:Color fade from slow to fast; 246-255:NoFunction)
4	0-255	first dot red dimmer.
5	0-255	first dot green dimmer.
6	0-255	first dot blue dimmer.
7	0-255	first dot white dimmer.
8	0-255	second dot red dimmer.
9	0-255	second dot green dimmer.
10	0-255	second dot blue dimmer.
11	0-255	second dot white c dimmer.
12	0-255	third dot red dimmer.
13	0-255	third dot green dimmer.
14	0-255	third dot blue dimmer.
15	0-255	third dot white dimmer.
16	0-255	fourth dot red dimmer.
17	0-255	fourth dot green c dimmer.
18	0-255	fourth dot blue dimmer.
19	0-255	fourth dot white c dimmer.
20	0-255	fifth dot red dimmer.
21	0-255	fifth dot green dimmer.
22	0-255	fifth dot blue dimmer.
23	0-255	fifth dot white dimmer.
24	0-255	sixth dot red dimmer.
25	0-255	sixth dot green dimmer.
26	0-255	sixth dot blue dimmer.
27	0-255	sixth dot white dimmer.

CLEANING AND MAINTENANCE

The following points have to be considered also during the inspection:

- 1) All screws for installing the devices or parts of the device have to be tightly connected and must not be corroded.
 - 2) There must not be any deformations on the housing, color lenses, fixations and installation spots (ceiling, suspension, trussing).
 - 3) The electric power supply cables must not show any damage, material fatigue or sediments.
- Further instructions depending on the installation spot and usage have to be adhered by a skilled installer and any safety problems have to be removed.



CAUTION!

Disconnect from mains before starting maintenance operation.

In order to make the lights in good condition and extend the life time, we suggest a regular cleaning to the lights.

Due to fog residue, smoke, and dust cleaning the internal and external optical lenses must be carried out periodically to optimize light output.

Clean the external optics with glass cleaner and a soft cloth.

Use also normal glass cleaner and a soft cloth to wipe down the outside casing.

Clean frequently the fans.

Cleaning frequency depends on the environment in which the unit operates.

We recommend a frequent cleaning of the device.

Please use a moist, lint free cloth.

Never use alcohol or solvents.

Should you need any spare parts, please order genuine parts.

Clean the external optics with glass cleaner and a soft cloth.

General specifications:

Model: QUADRO B24

Voltage: 110V-230V / 60Hz-50Hz

Colors: RGBW Color Mixing

LED: 24 PCS 1W LEDs, Red x 6 pcs; Green x 6 pcs; Blue x 6 pcs;

White:6pcs.

Gross Weight: 5.5Kgs

Dimensions: 460(L) x 120(W) x 340(H) mm

Batteries specifications:

Rechargeable Battery with up to 18 hours of battery life

Battery power indicator 0-100% 18650 type, 2200MA/Unit

Charging voltage: 4.2V

Charging current: 7A

Maximum capacity: 46Ah

Maximum output current: 7A

Standard charge time: 8hours

Discharge cut-off voltage: 2.75V

Circulation life: 500 times

DMX Wireless specification:

Wireless DMX-512 protocol

Built in 2.400G-2.525 receiver / transmitter for wireless DMX

126 auto jumping channel

frequencies, high anti-jamming

ability to ensure work reliability

7 ID codes for multiple

transmitters and receiver use

Wired DMX-512 protocol

Note: All information is subject to change without prior notice.